

PL 11 - PLK 13 - PLE 12 with mounting profile

Content

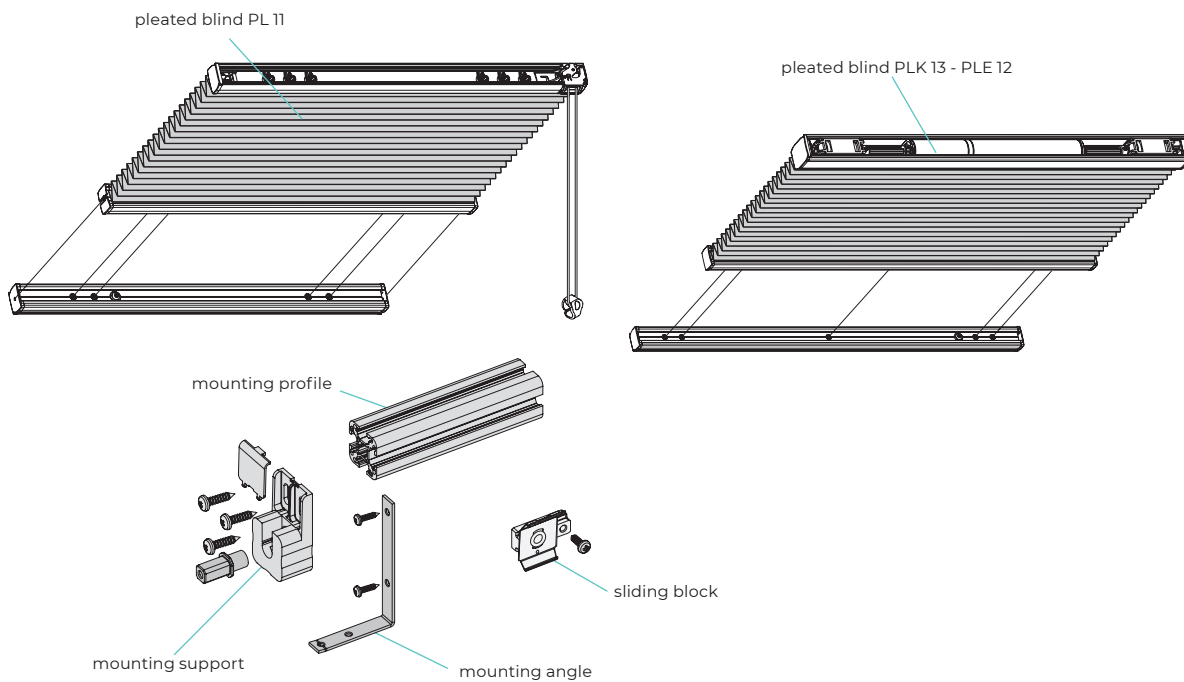

Placement of the clips on the profile

Make sure that the distance between the clip and the end of the pleated blinds is 50 or 65 mm.

bottom profile PL 11 - PLK 13 - PLE 12 + top profile PL 11

top profile PLK 13 - PLE 12

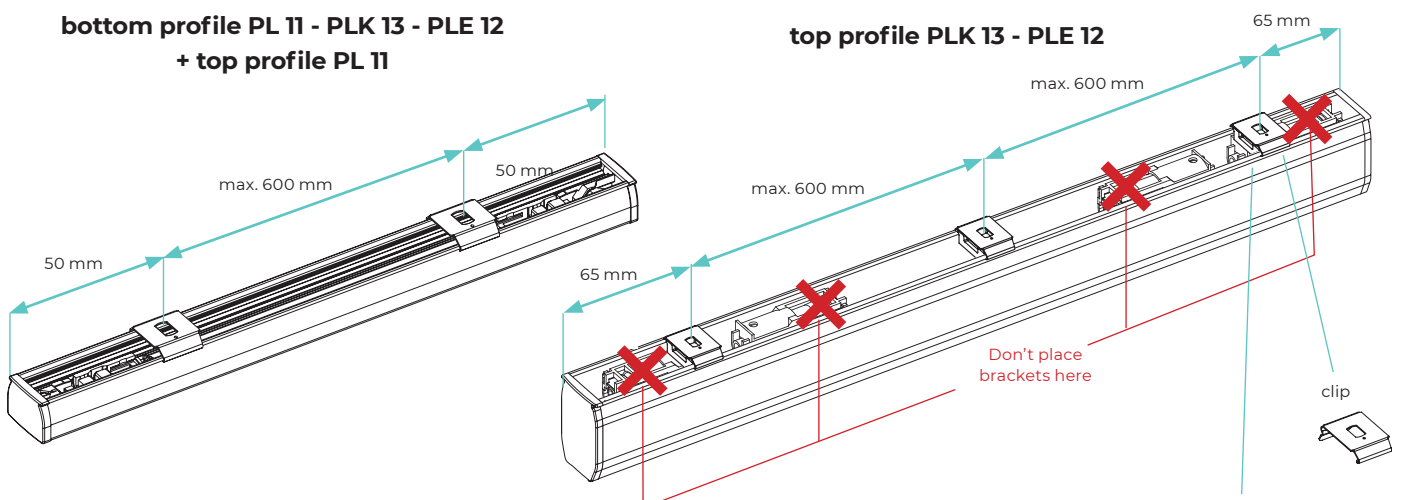

Attention! Make sure the brackets are not fixed on top of the spools in the headrail.

Mounting of the pleated blind

- 1 Mount the mounting support or mounting angle to a flat surface.

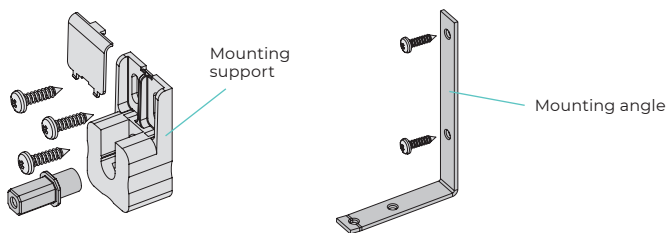

- 2 Attach the mounting profile to the mounting support or mounting angle.

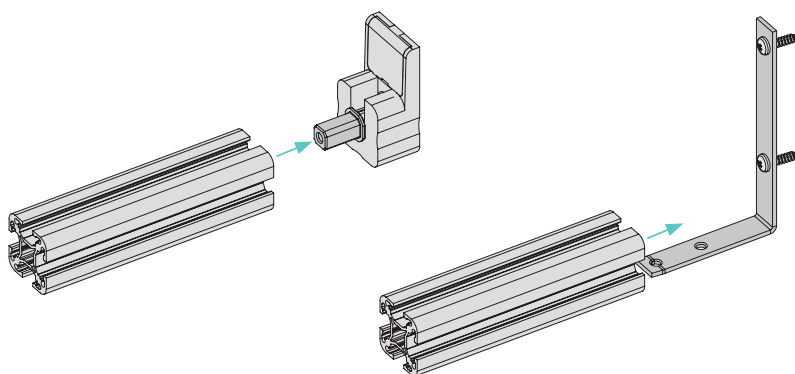

- 3 Add the sliding blocks to the mounting profile.
Use the screw to fit the sliding block into the mounting profile.

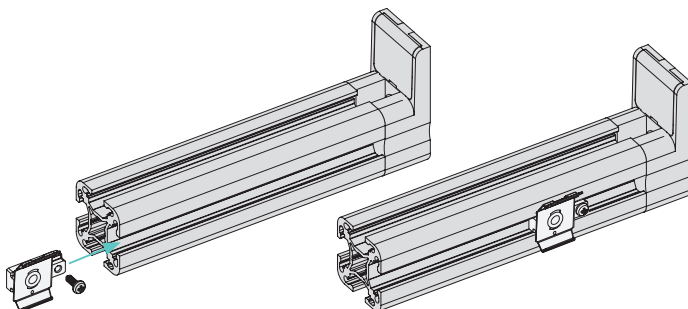

- 4 Insert the profile in the bottom edge of the clip and press it upwards (until it clicks).

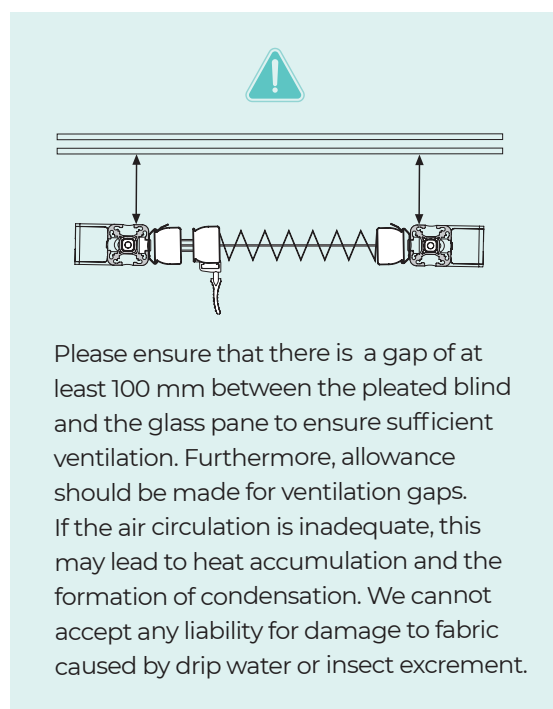
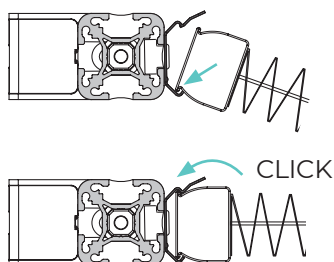

Tension the wire

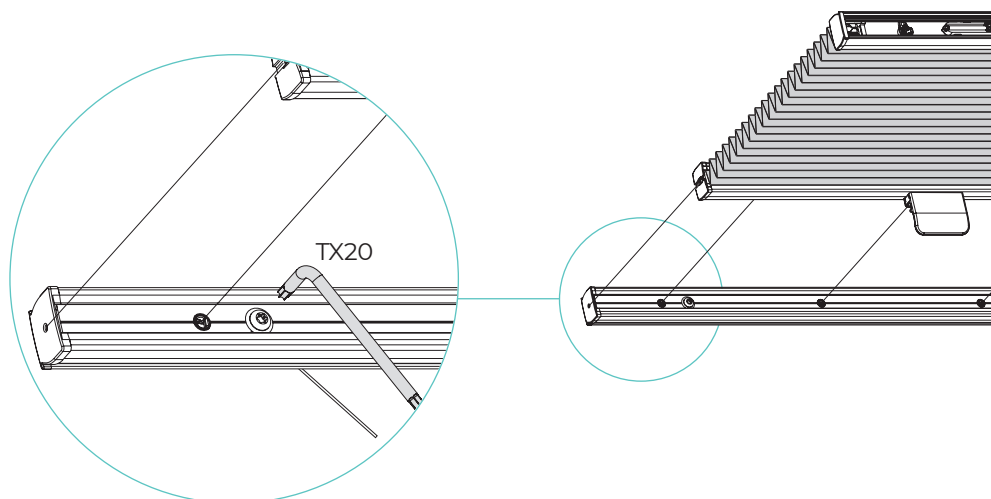

- 1 Secure the end of the wire by hand or using pliers.
- 2 Release the screw (TX20) slightly (turn anti-clockwise).
- 3 Tension the wire (by hand or use pliers).
- 4 Tighten the screw (turn clockwise).
- 5 Cut off the excess cord ends.



For pleated blinds with more than 1 wire, repeat steps 1 to 4. Do this before starting step 5.

Operation PL 11

The PL 11 system is opened and closed by moving the operating handle, using the control rod if necessary.

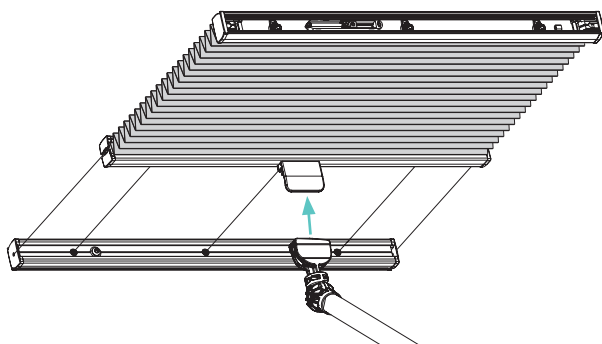

Operation PLK 13

The PLK 13 system is opened or closed by turning the crank handle. Attach the crank handle to the crank gear box.

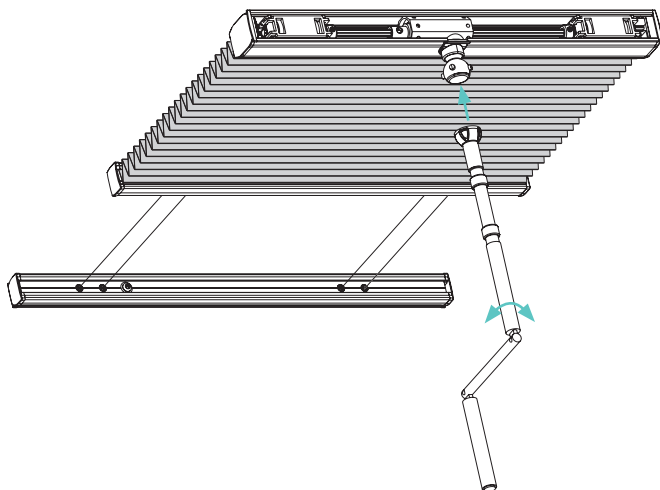

Operation PLE 12

The PLE 12 system is a motorised system. Consult the electric installation instruction for a correct installation.

